



**The Dolomite Centre Ltd.**  
 Unit 1, Anglian Business Park, Orchard Road,  
 Royston, Hertfordshire, SG8 5TW, UK  
**T:** +44 (0)1763 242491  
**F:** +44 (0)1763 246125  
**E:** dolomitesales@syrris.com  
**W:** www.dolomite-centre.com

**The Dolomite Centre Limited**  
 Registered office: 27 Jarman Way,  
 Royston, Hertfordshire, SG8 5HW, UK  
 Company No. 05640084

# INFORMATION SHEET

Part name	Mitos Chip with Header 8-way	Part number	3000096
-----------	------------------------------	-------------	---------

## Description

The Mitos Chip Header works in conjunction with the 8-way Edge Connector (part number 3000102), providing fluidic connections to the edge of a glass microfluidic chips. The chip header is compatible with chips that are 4mm thick and 30mm wide. The combination of the edge connector and header provides fast and reliable connection between Dolomite chips and 1.6mm tubing.

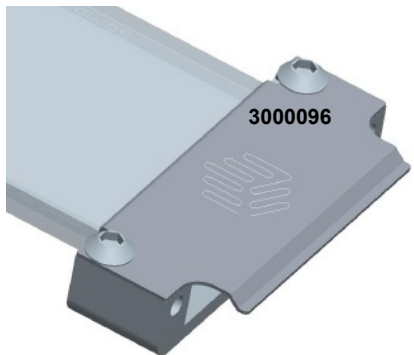

Microfluidic Chip with 8-way Header

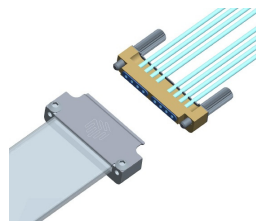

Perfluoroelastomer seal (FFKM). Part number 3000021.

8-way Edge Connector and chip with header

## Benefits

- Compact
- Low dead volume
- Quick connect/disconnect
- Wide temperature and pressure range
- Low cost
- Excellent chemical compatibility

	Edge connector specification	Value
1	Number of ports	8
2	Chip thickness options	4 mm
3	Chip width options	30 mm
4	Chip length options	10 mm – 90 mm
5	Outside diameter of connection tubing	1.6 mm (1/16 inch)
6	Inside diameter of connection tubing	0.25 mm, 0.5 mm, 0.8 mm
7	Connection tubing material	PTFE, FEP
8	Operating pressure	10 Bar
9	Operating temperature range of seal	-15 to 260 °C
10	Wetted materials	Glass, PTFE, and perfluoroelastomer
11	Connector materials	PEEK, Stainless Steel 316
12	Dead volume	< 0.1 µl per port

### Cross-sectional view of sealing interface

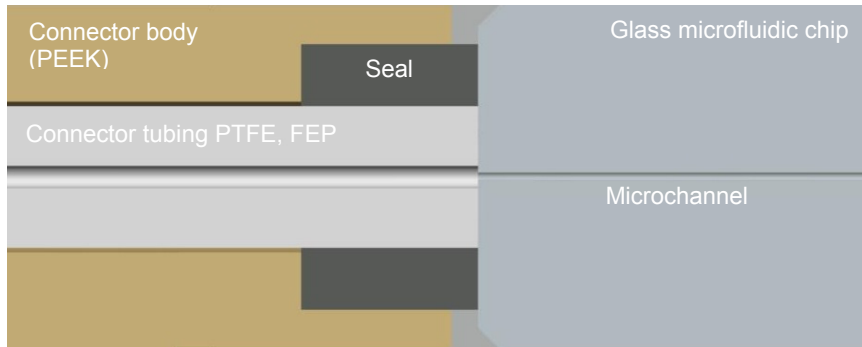

### Microfluidic chip with header geometry (with 60mm long chip)

